

clik[®]

TILE SYSTEM

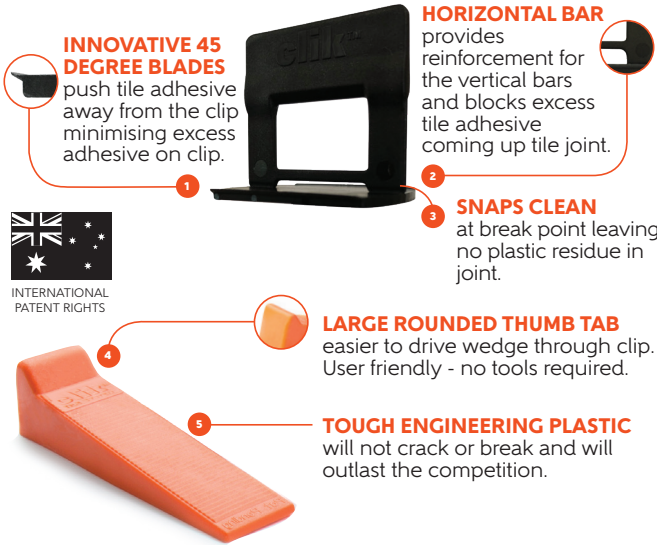

INSTRUCTIONS

- 1 Spread tile adhesive on floor and/or walls/or back of tiles.
- 2 Place Clip approximately 100-ISOmm from the tile corner. For an even better finish, additional clips can be placed in the middle of the tile or where the four tiles meet.
- 3 After the clips have been placed you can then drive the wedge home through the openings using your thumb/ finger. For that extra drive you can use your palm.
- 4 Once the tile adhesive is set the clip system is ready to be removed and ready for grouting.
- 5 By kicking with the foot or a rubber mallet, hit the clip on the side and always in the same direction of the grout lines.

3 EASY STEPS

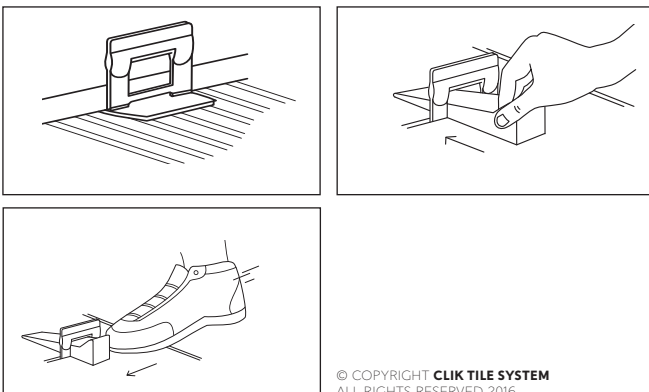

PRODUCT TECH SHEET



CLIPS
100, 500, 2000 Box
1.1mm
1.5mm
1.9mm
3.0mm
14-22mm STONE

WEDGES
100, 500, 2000 Box

STARTER PACK
400 Clips and 250 Wedges



CONSUMPTION CALCULATOR

	200	250	300	330	400	450	500	600	800	900	1000	1200	
A = Tile Length (mm)	200	50	80	66	60	50	44	40	33	25	22	20	17
	250	40	32	53	48	40	35	32	27	20	18	16	30
	300	50	40	44	40	33	30	27	22	17	15	13	11
	330	45	36	49	37	30	27	25	20	15	13	12	10
	400	37	30	33	30	25	22	20	17	13	11	10	8
	450	33	27	30	27	22	20	8	15	11	10	9	7
	500	30	24	27	24	20	18	16	14	10	9	8	7
	600	25	20	22	20	17	15	13	11	8	7	7	6
	800	25	20	21	19	16	14	12	10	9	6	5	4
	900	22	18	19	17	14	12	11	9	8	7	5	4
	1000	25	20	20	18	15	13	12	10	9	8	8	4
	1200	21	17	17	15	13	11	10	8	7	6	7	6
		200	250	300	330	400	450	500	600	800	900	1000	1200
		B = Tile Length (mm)											

A = pcs/m²
B (600mm)
B (300mm)
= 22pcs/m²

AUSTRALIAN MADE AND OWNED