

## 'PROJECT' Floor Drains

**Product Code:**SGNL-T 115/50BLK / 1221182

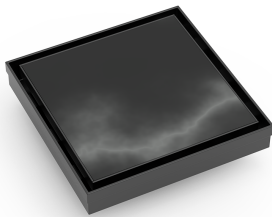

Bella Vista

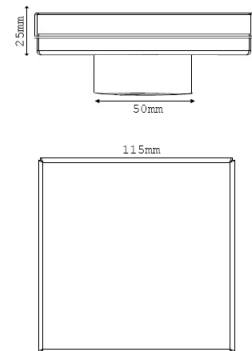
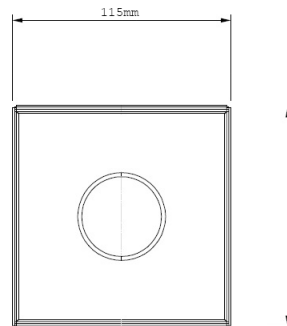

### Specifications:

<b>Style</b>	Tile Insert 115x115mm Floor Drain
<b>Material</b>	304 Grade stainless steel
<b>Finish</b>	Electrostatic black finish
<b>Dimensions</b>	115mm (l) x 115mm (w) x 25mm (d)*
<b>Outlet Size</b>	50mm
<b>Details</b>	<p>Suitable for commercial and residential</p> <p>Watermark approved</p> <p>Also available with 90mm outlet size</p> <p>* Depth is for drain body and does not include outlet</p>
<b>Warranty</b>	12-month warranty (refer to <a href="https://bella-vista.net.au">bella-vista.net.au</a> for details)