

Polyurethane Aluminium Movement Joints - 3metre

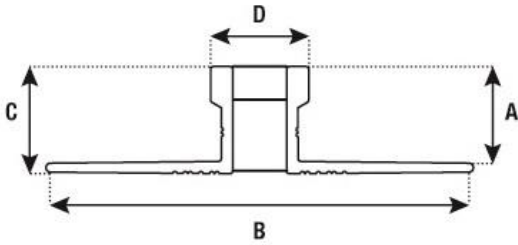

- Prefabricated movement joint designed to allow for expansion and contraction of floor tiles
- Polyurethane insert available in both grey and black. Other colours available on request
- Shore hardness of 45
- Aluminium angles protect edge of tiles from damage
- Installed over construction joints
- Conforms with Australian Standard AS 3958



Size A	B	C	D (6mm)
8mm	52mm	9.2mm	11mm
10mm	52mm	11.2mm	11mm
12.5mm	52mm	13.7mm	11mm
15mm	52mm	16.2mm	11mm
18.5mm	52mm	19.7mm	11mm
22mm	52mm	22.5mm	11mm

ALLOY: 6063 TEMPER: T5

CHEMICAL CONTENT										
STANDARD	SILICONE (%)	IRON (%)	COPPER (%)	MANGANESE (%)	MAGNESIUM (%)	CHROMIUM (%)	ZINC (%)	TITANIUM (%)	OTHER (each 0.05%) (%)	ALUMINIUM (%)
(DIN/BS) EN 573-3;1994 (DIN/BS) EN 755-2;1997	0.20-0.60	0.35	0.1	0.1	0.45-0.90	0.1	0.1	0.1	0.15	Rem
MECHANICAL PROPERTY										
STANDARD	DIMENSION (mm)	0.2% Proof Stress minimum (N/mm ²)	Tensile Strength minimum (N/mm ²)	Elongation (%)	Elongation on 50mm (%)					
(DIN/BS) EN 573-3;1994 (DIN/BS) EN 755-2;1997	≤3	130	175	8	6					
	3C=25	110	160	7	5					

6mm wide		8mm	10mm	12.5mm	15mm	18.5mm	22mm	
Colour		Code	Code	Code	Code	Code	Code	Pk Qty
	Grey	PACG3A08X6G	PACG3A10X6G	PACG3A12X6G	PACG3A15X6G	PACG3A18X6G	PACG3A22X6G	10
	Black	PACG3A08X6BL	PACG3A10X6BL	PACG3A12X6BL	PACG3A15X6BL	PACG3A18X6BL	PACG3A22X6BL	10